

Aluminum Deflection Gauge Kits

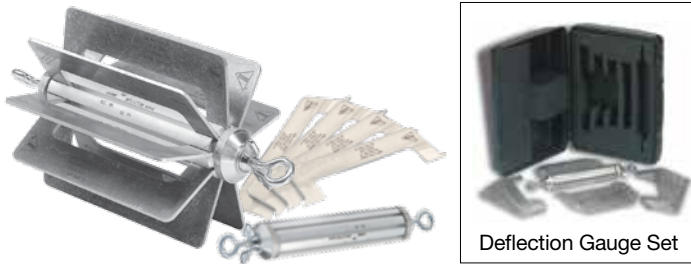

Deflection Gauge Set

Field Verification:

Cherne's Aluminum Fin Style Deflection Gauges are designed to be field verified by inspectors without the use of a proving ring. Simply place two fins end-to-end as pictured below (1) and measure the width. Add one inch to the mandrel (2) and you have the outside dimension of the gauge. Using this method simplifies the inspector's job of verifying sizes on deflection gauges.

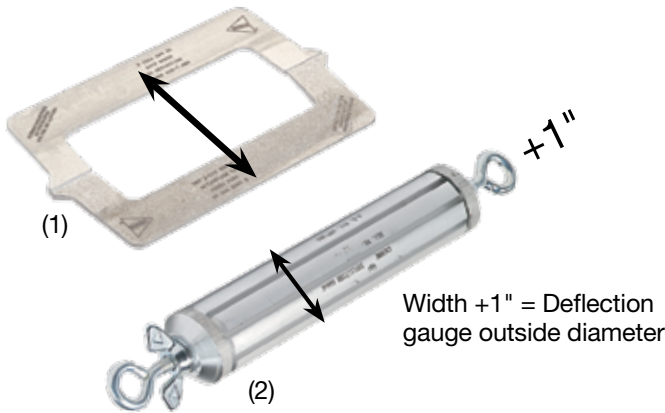

Aluminum Fin Style Deflection Gauge:

- Lightweight, corrosion-resistant
- Field-verifiable without a proving ring
- Assembles without tools
- All sizes fit through standard 24" manhole
- Fins for 4"-15" gauges have skid size equal to the nominal pipe size—gauge will meet regional codes and will not tip in the line
- Nine-fin design ensures testing accuracy
- Open design allows gravel and debris pass-through

5% Aluminum Fin Set Deflection Gauge Kits (Fin Sets, Core Mandrel and Carrying Case)

Kits for SDR 26 Pipe per ASTM D3034					
Part Number	Nominal Size	Average Pipe I.D.	Base Pipe I.D.*	Pipe I.D. @ Defl.	Product Wt.
285688	6"	5.764"	5.612"	5.33"	18 lbs.
	(152.40 mm)	(146.41 mm)	(142.54 mm)	(135.38 mm)	
	8"	7.715"	7.488"	7.11"	
285698	10"	9.644"	9.342"	8.87"	19 lbs.
	(254.00 mm)	(244.96 mm)	(237.29 mm)	(225.30 mm)	
	8"	7.715"	7.488"	7.11"	
285699	10"	9.644"	9.342"	8.87"	19 lbs.
	(254.00 mm)	(244.96 mm)	(237.29 mm)	(225.30 mm)	
	12"	11.480"	11.102"	10.55"	
285698	12"	11.480"	11.102"	10.55"	19 lbs.
	(304.80 mm)	(291.59 mm)	(281.99 mm)	(267.97 mm)	
	8"	7.715"	7.488"	7.11"	

Kits for SDR 35 Pipe per ASTM D3034					
Part Number	Nominal Size	Average Pipe I.D.	Base Pipe I.D.*	Pipe I.D. @ Defl.	Product Wt.
285005	6"	5.893"	5.742"	5.46"	18 lbs.
	(152.40 mm)	(149.68 mm)	(145.85 mm)	(138.68 mm)	
	8"	7.891"	7.665"	7.28"	
285021	10"	9.864"	9.563"	9.09"	19 lbs.
	(254.00 mm)	(250.55 mm)	(242.90 mm)	(230.89 mm)	
	8"	7.891"	7.665"	7.28"	
285021	10"	9.864"	9.563"	9.09"	19 lbs.
	(254.00 mm)	(250.55 mm)	(242.90 mm)	(230.89 mm)	
	12"	11.737"	11.360"	10.79"	
285021	12"	11.737"	11.360"	10.79"	19 lbs.
	(304.80 mm)	(298.12 mm)	(288.54 mm)	(274.07 mm)	
	8"	7.891"	7.665"	7.28"	

7.5% Aluminum Fin Set Deflection Gauge Kits (Fin Sets, Core Mandrel and Carrying Case)

Kits for SDR 26 Pipe per ASTM D3034					
Part Number	Nominal Size	Average Pipe I.D.	Base Pipe I.D.*	Pipe I.D. @ Defl.	Product Wt.
Custom Kit Consult Factory	6"	5.764"	5.612"	5.19"	18 lbs.
	(152.40 mm)	(146.41 mm)	(142.54 mm)	(131.80 mm)	
	8"	7.715"	7.488"	6.93"	
Custom Kit Consult Factory	10"	9.644"	9.342"	8.64"	19 lbs.
	(254.00 mm)	(244.96 mm)	(237.29 mm)	(219.50 mm)	
	8"	7.715"	7.488"	6.93"	
Custom Kit Consult Factory	10"	9.644"	9.342"	8.64"	19 lbs.
	(254.00 mm)	(244.96 mm)	(237.29 mm)	(219.50 mm)	
	12"	11.480"	11.102"	10.27"	
Custom Kit Consult Factory	12"	11.480"	11.102"	10.27"	19 lbs.
	(304.80 mm)	(291.59 mm)	(281.99 mm)	(260.90 mm)	
	8"	7.715"	7.488"	6.93"	

Kits for SDR 35 Pipe per ASTM D3034					
Part Number	Nominal Size	Average Pipe I.D.	Base Pipe I.D.*	Pipe I.D. @ Defl.	Product Wt.
285013	6"	5.893"	5.742"	5.31"	18 lbs.
	(152.40 mm)	(149.68 mm)	(145.85 mm)	(134.90 mm)	
	8"	7.891"	7.665"	7.09"	
285048	10"	9.864"	9.563"	8.85"	19 lbs.
	(254.00 mm)	(250.55 mm)	(242.90 mm)	(224.80 mm)	
	12"	11.737"	11.360"	10.51"	
285048	12"	11.737"	11.360"	10.51"	19 lbs.
	(304.80 mm)	(298.12 mm)	(288.54 mm)	(267.00 mm)	
	8"	7.891"	7.665"	7.09"	

Base inside diameter (Base Pipe I.D.) allows for our of roundness and wall thickness tolerances as defined by ASTM standards.
Custom kits available - consult factory